

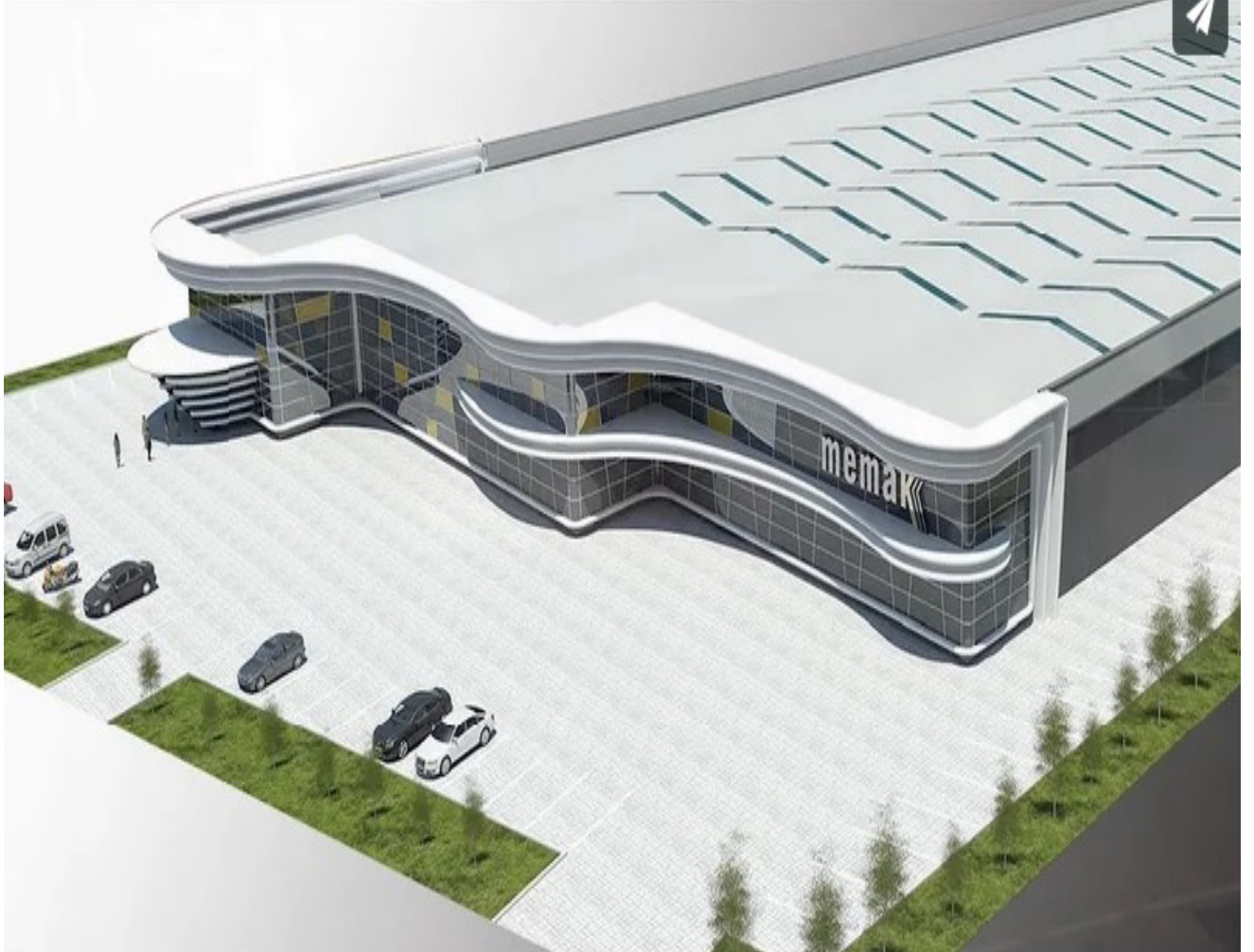

OPERATING AND MAINTENANCE MANUEL



4.Organize Sanayi Bölgesi 103 cad. No:10 Konya-Turkey

Tel: +900 332 345 36 16 Fax: +900 332 345 36 26 Web: www.memak.com e-mail: memak@memak.com

MANUFACTURER NOTE

- *Please read this manual carefully before installation and operating of the machine, ensure that the operators read. The warranty does not cover the machine if you run the machine without reading the manual.*
- *The manual that gives information about installation, operating and maintenance should be read carefully. Electrical installation to be connected to the machine should be performed by qualified staff in accordance with the laws and regulations. It should be prepared, before coming of authorized service technician for installing of the machine.*
- *If you have questions regarding unclear issues, please do not hesitate to call us.*
- *We kindly remind that the costs and waiting costs will be charged to you, in case of keeping the installation technician waiting.*
- *We hope that you obtain the most efficiency from our product.*

- *Dear user,*
- *We thank you for prefer our product and confidence in us. We have been exporting our machines to many countries including yours.*
- *Our machines are manufactured according to international standards.*
- *To acquire optimal performance from the product and longtime usage, please read the operating manual*

IMPORTANT NOTES

- *The materials which are guaranteed by our machine has 2 years warranty*
- *The following points are not covered by the warranty*
- *Placing the machine to the scale and fixing*
- *Not lubricating the areas shown in the manual on time.*
- *Operating the machine over than its capacity.*
- *Electrical equipments and engines.*
- *Memak is not going to be responsible for the damages arising from the applications which Memak Machinery has neither approved, nor declared, nor given information and instruction, nor provided technical support*
- *Please make your request using the spare part numbers or names in the schedule of the given sections and disassembly pictures.*
- *Before using the machine, please carefully read this manual.*
- *In case of not following the instructions strictly, a dangerous accident may occur.*
- *Technical works on the system and on the machine must be performed by authorized and qualified persons.*
- *In case of any defect in our machines or your complaint, you can contact through below phone number or address.*

STEAM CHAMFER

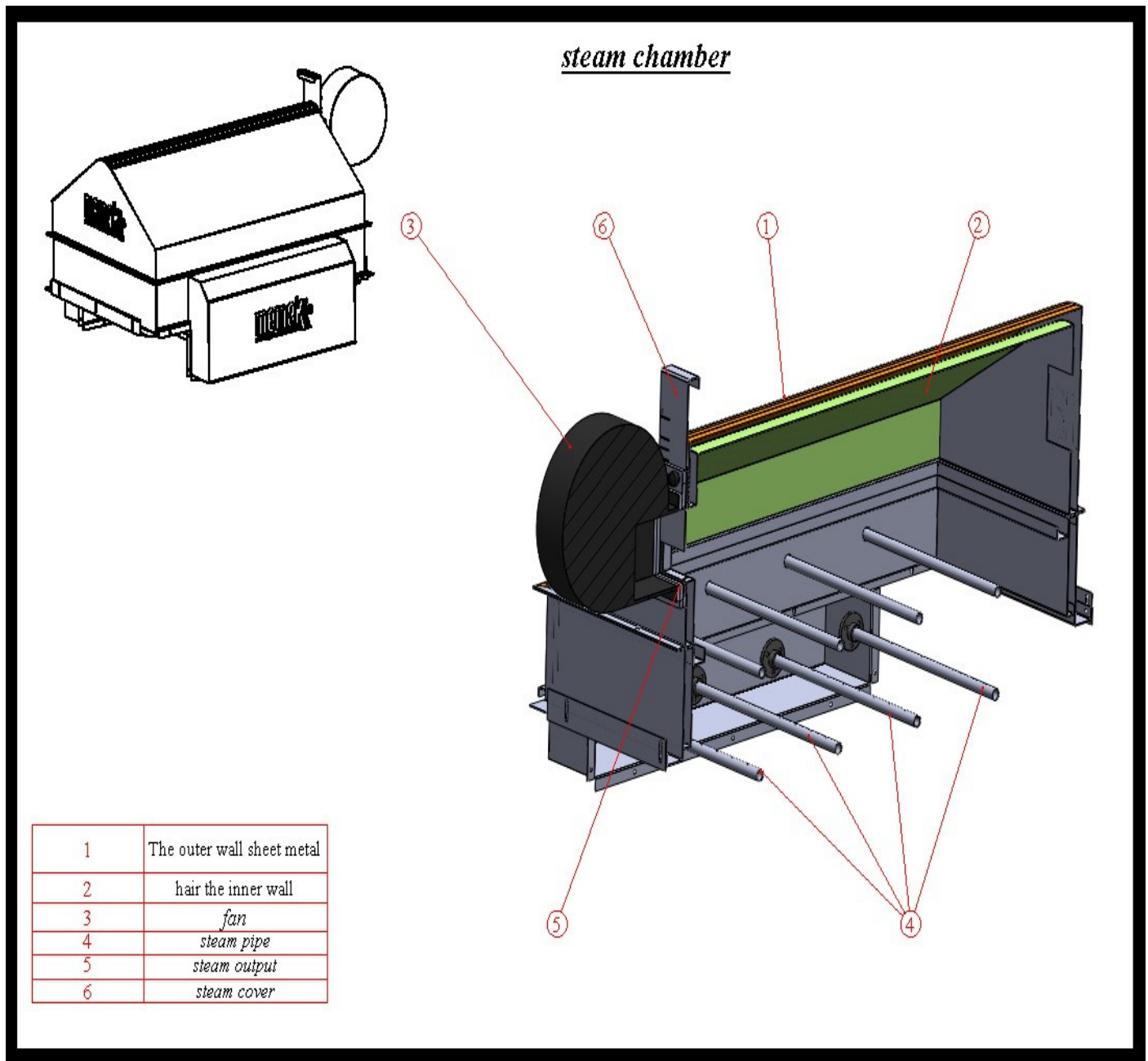

- ❖ *two reservoir wall.*
- ❖ *thermal insulation of the reservoir.*
- ❖ *there is a water channel in it.*
- ❖ *disturbing steam evacuation fan on the burner is available.*
- ❖ *output level can be adjusted with the throttle steam hair.*

STEAMY WIRE CONVEYOR BELT

steamy wire conveyor belt

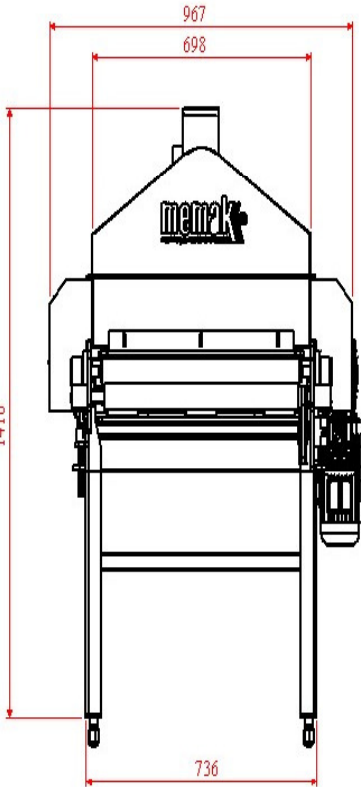
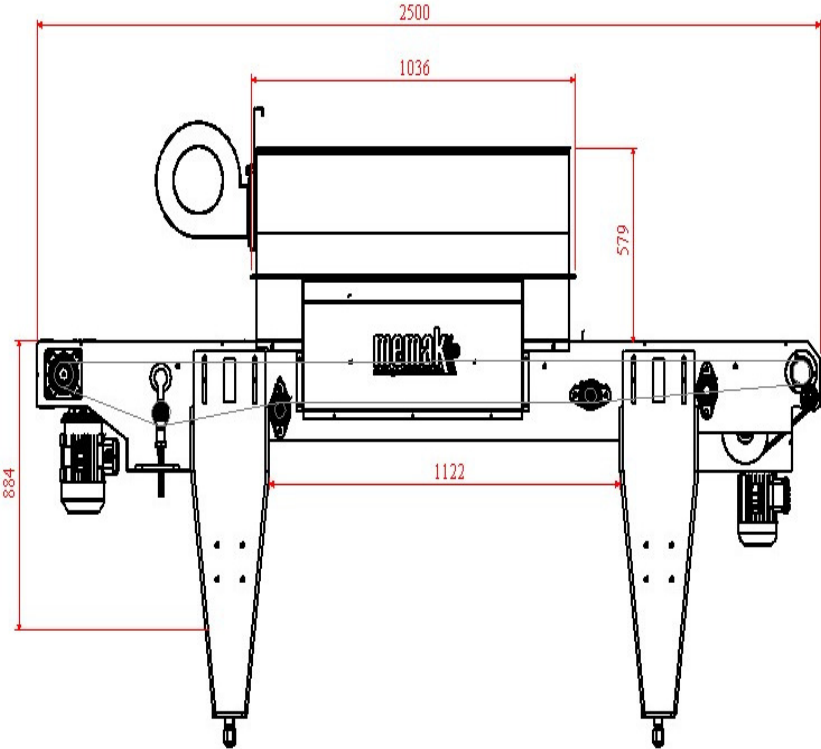
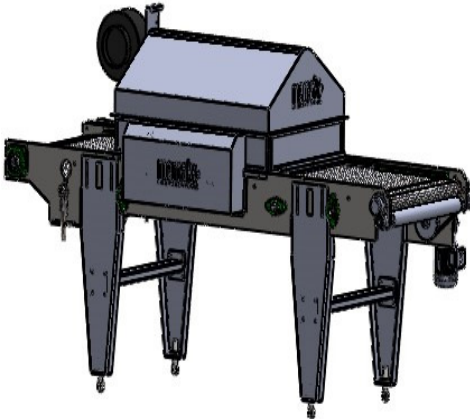

STEAMY WIRE CONVEYOR BELT

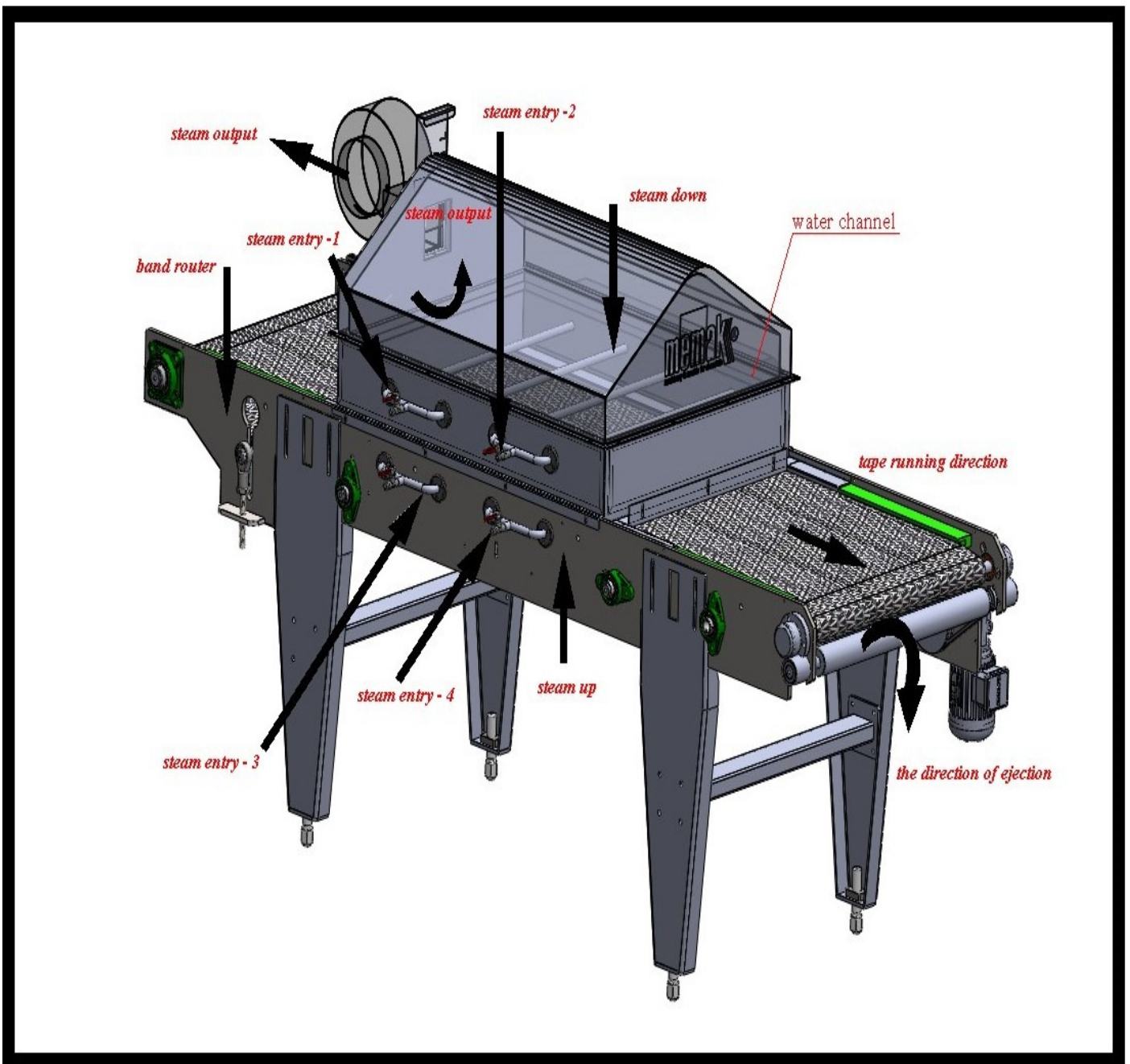

- ❖ the working system of the conveyor belt is working in the direction of the arrow.

MATERIAL NAMES

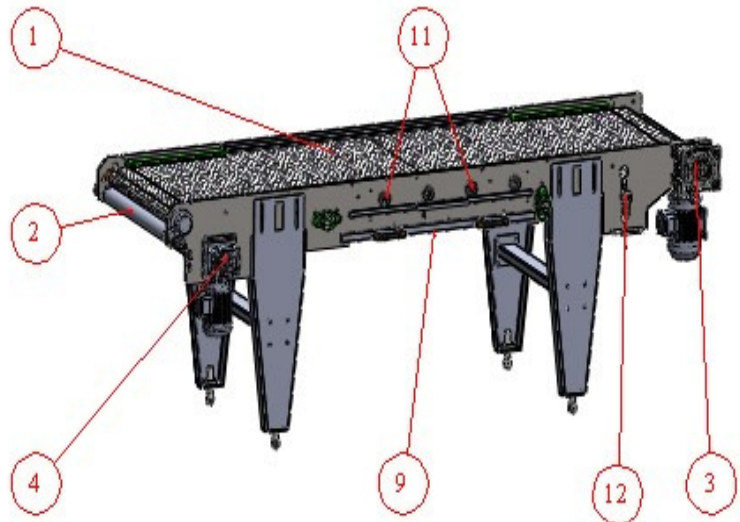
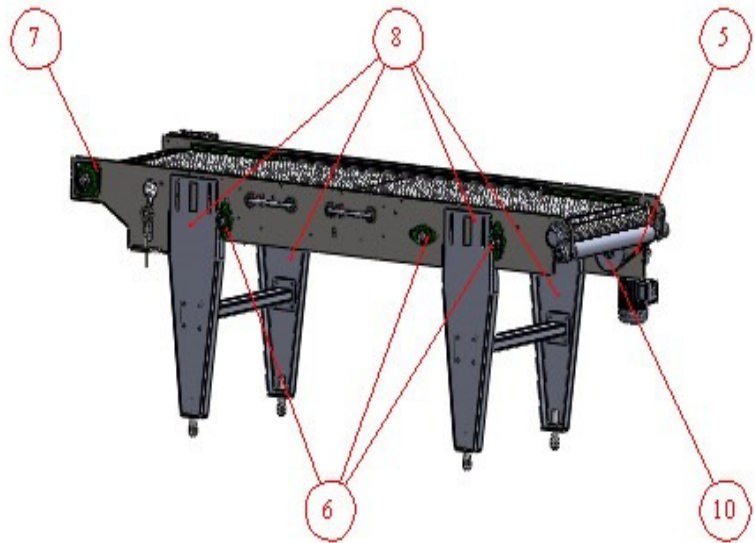

1	wire mesh band
2	throwing ball
3	En 063 1.5 kw 1400 d/ik geared motor
4	EN 040 0.37 kw 1400 d/ik geared motor
5	trigger strap
6	ucfl 205 bearing
7	ucf 207 bearing
8	mounting brackets
9	water reservoir
10	timing pulley
11	steam pipe
12	phs 20 bearing

MOVING THE MACHINE

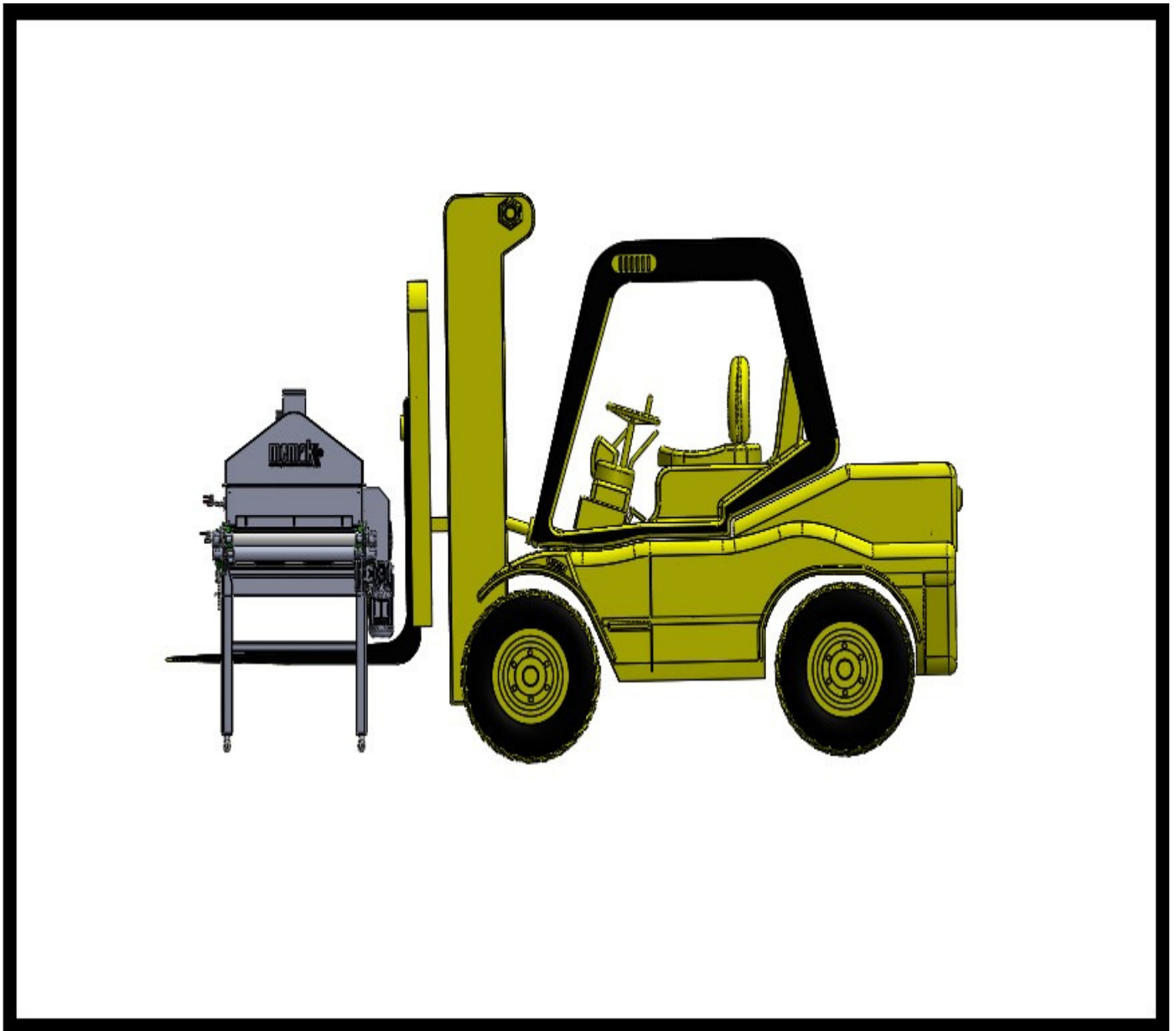

1 - move operation is performed while the machine (or part of) the center of gravity should be taken into account in the most appropriate way, without any damage to the machine, and you must be performed without exposing to risk the health of the staff.

2- of the machine during transportation, careless, skew removal and moving can disrupt the main body. Therefore the transport process should be done carefully.

LUBRICATION AND MAINTENANCE

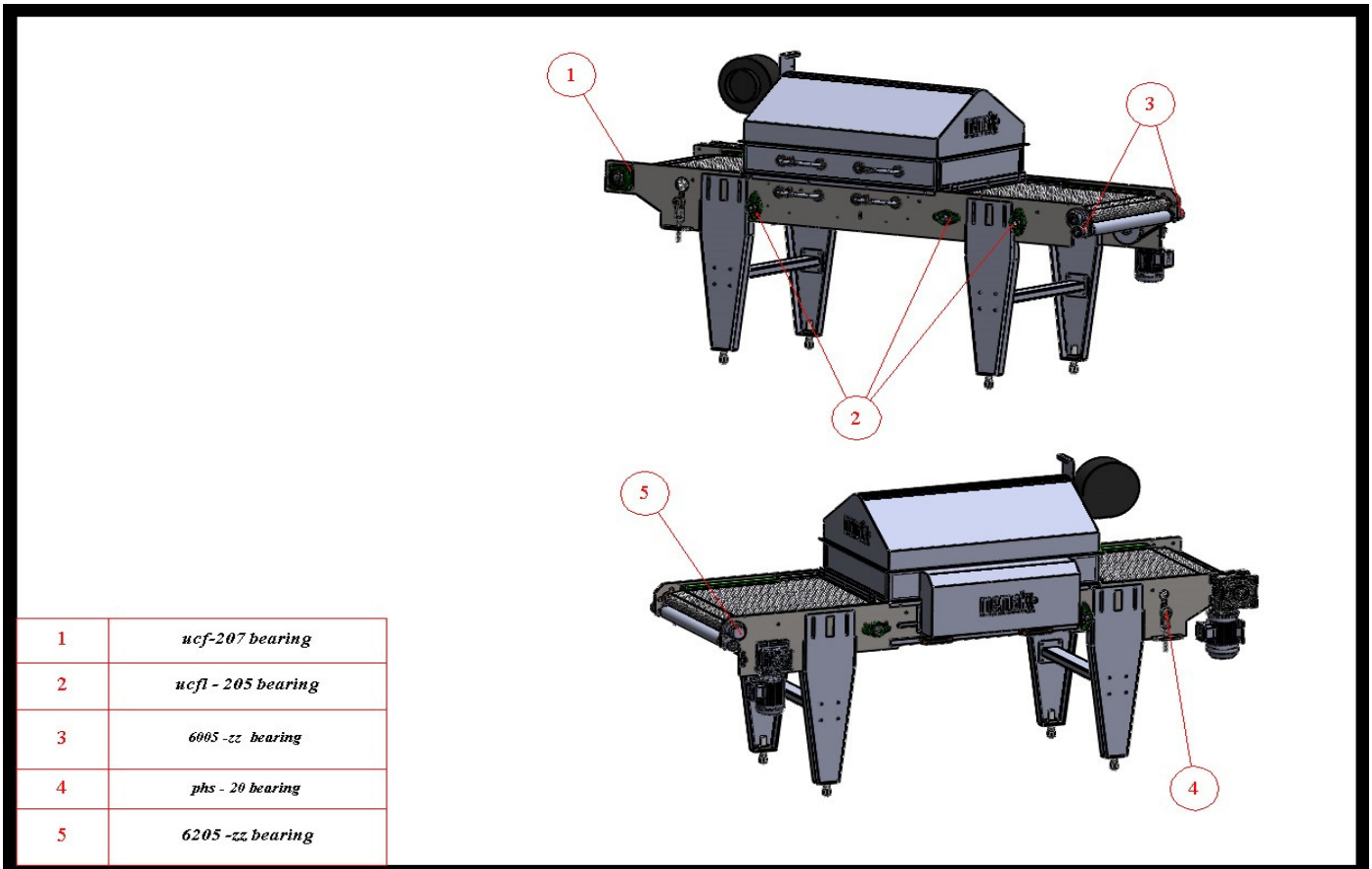

- ❖ *firstly the machine should be taken to scale.*
- ❖ *lubrication should be done once a month necessarily*
- ❖ *enumerated commodities.*
- ❖ *at the business end, not necessarily the cleaning of the machine should be done.*
- ❖ *bearings, sugar, and water must be protected.*
- ❖ *do you control steam pressure*
- ❖ *make sure steam is inserted in the housing installation.*
- ❖ *check that there is leakage in Steam systems.*
- ❖ *steam installation should not be touched with your hand.*
- ❖ *do not intervene manually while the machine is running.*

SUGAR COATING DRUM

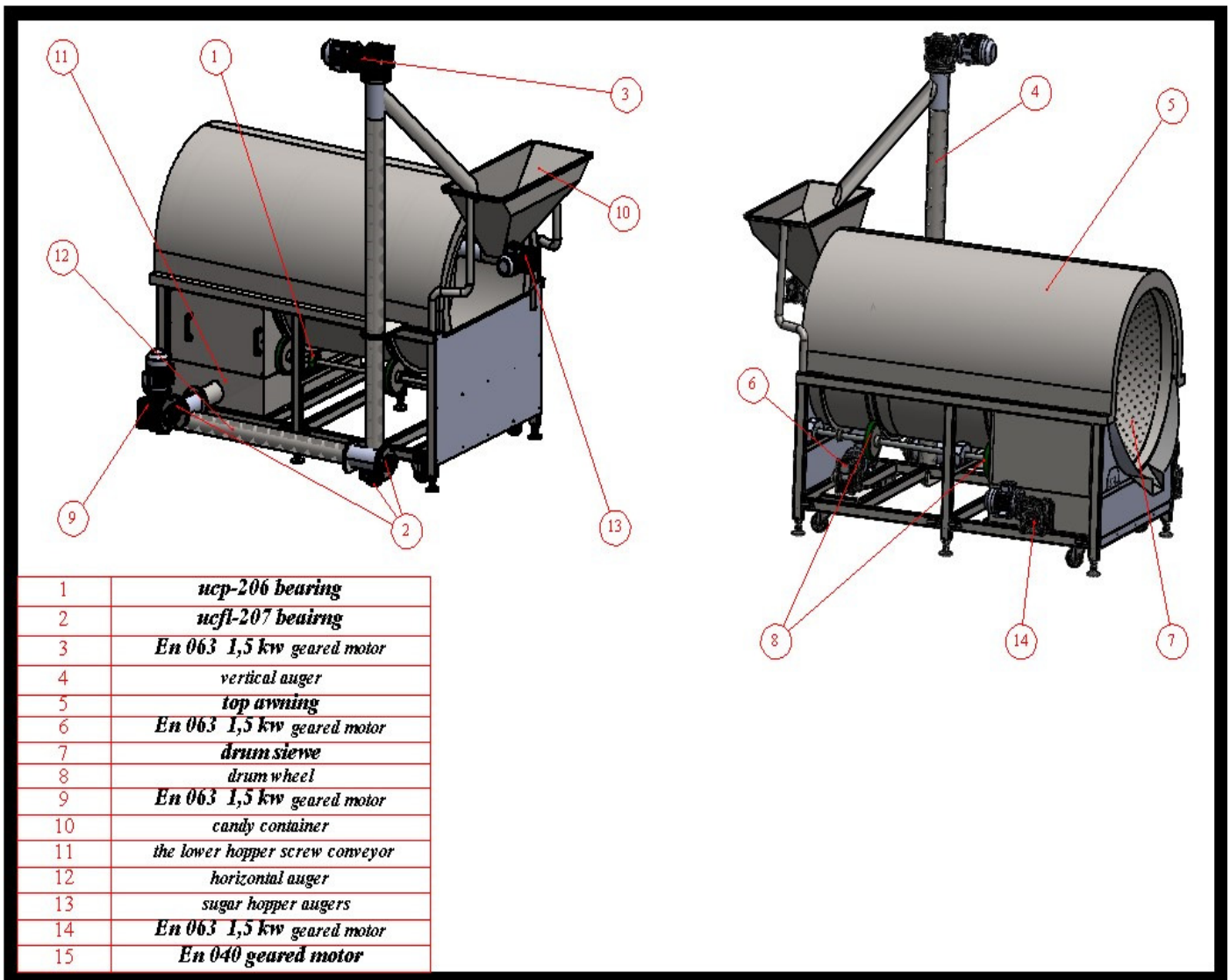

LUBRICATION AND MAINTENANCE

- ❖ *bearing and bearing oil once a month.*
- ❖ *chain drive oil control check of the system once a month.*
- ❖ *at the end of each job, not necessarily to be used for the cleaning of the machine.*
- ❖ *while the machine is running do not interfere with the Helix.*
- ❖ *do not interfere with the inside of the drum while the machine is running.*
- ❖ *protect the sugar from moisture and water inside the reservoir.*
- ❖ *check the tightness of the seal inside the hive.*
- ❖ *seek balance drum by conveyor belts.*
- ❖ *sugar into the Chamber do not intervene.*

OPERATING SYSTEM

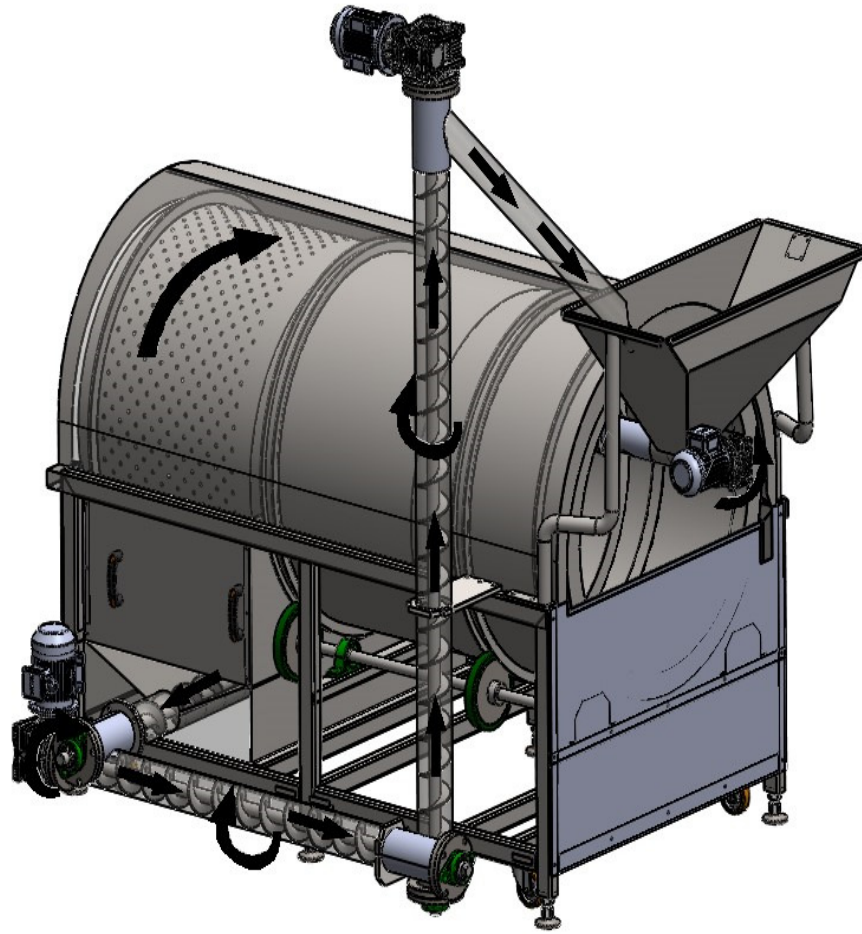

- ❖ Helix-turn in the direction of the arrow.
- ❖ that is stored in the lower reservoir and upper reservoir through the circulation of sugar transported into the augers to be supplied.
- ❖ the movement is driven from the wheel system with the help of the mixture is achieved by passing the chain drum.
- ❖ boasting more regular Helix within the drum can blend with folds.
- ❖

MOUNT IMAGE

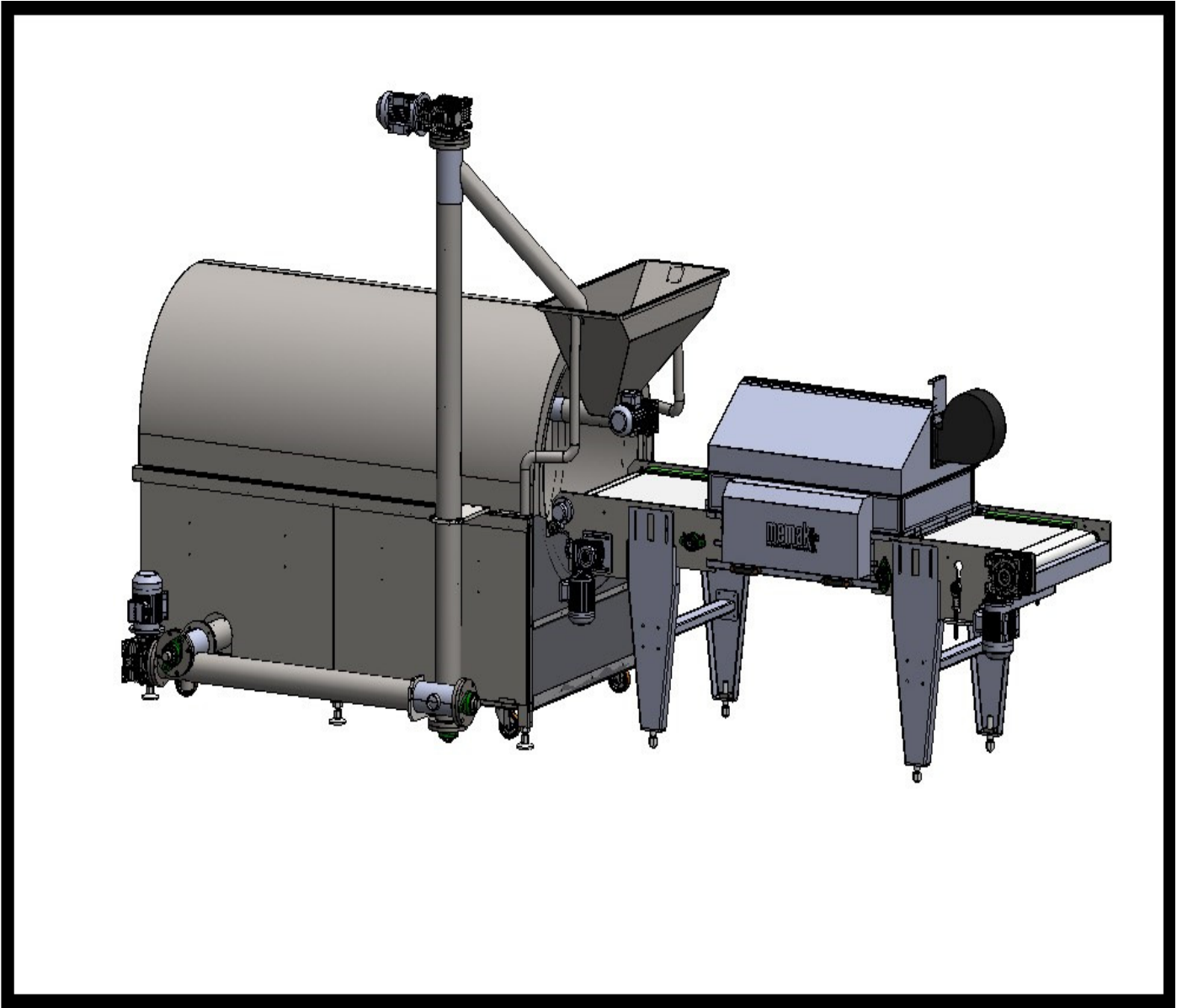

- ❖ balance is taken to the coating drum, and the setup is done. then according to the coating drum conveyor belt system is adapted.
- ❖ star is given from the Control Panel.
- ❖ the operating system is automatic. with each other dependent is working.
- ❖ the speed adjustment potentiometer on the Control Panel.

DRUM SIZE

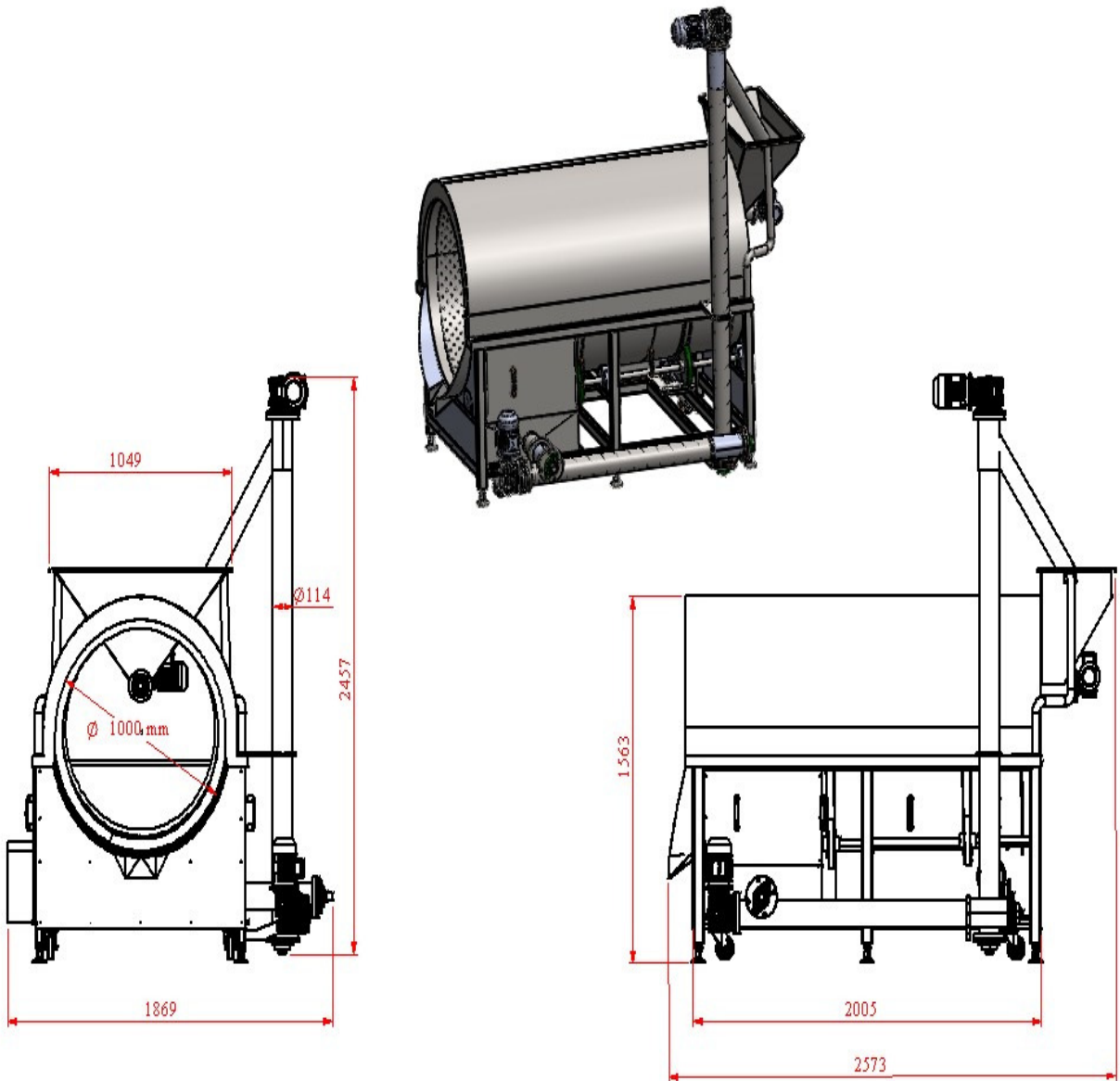



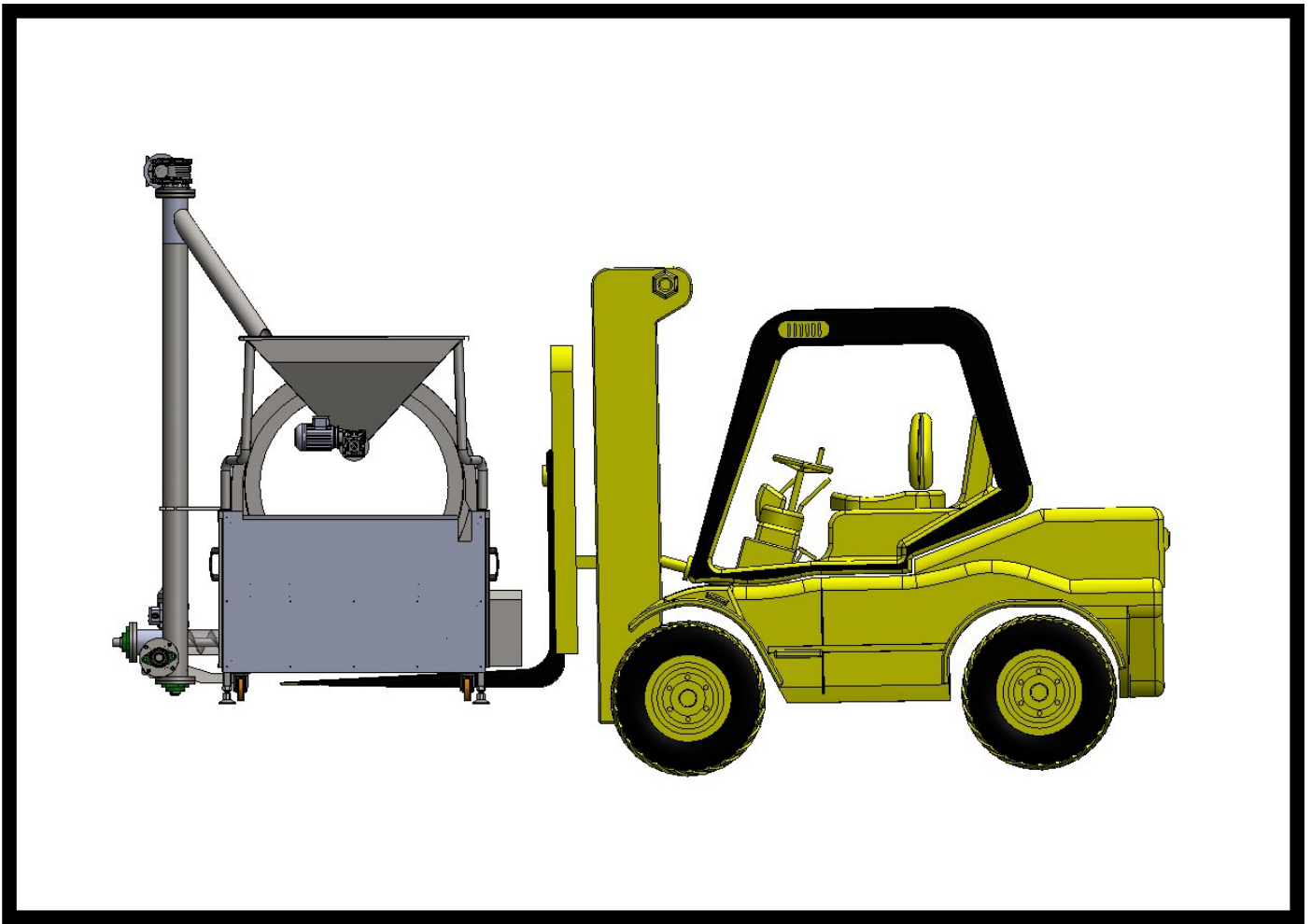



MOVING THE MACHINE



1 - move operation is performed while the machine (or part of) the center of gravity should be taken into account in the most appropriate way, without any damage to the machine, and you must be performed without exposing to risk the health of the staff.

3- of the machine during transportation, careless, skew removal and moving can disrupt the main body. Therefore the transport process should be done carefully.

LUBRICATION OF THE MACHINE

Lubricant	Usage Temperature	ISO Viscosity Class							
<i>Mineral Oil</i>	0 ... +100	ISO VG 680	Degol BG 680	Energol GR-XP680	Spartan EP 680		Mobilgear 636	Omala 680	Alpha SP 680
	0 ... +100	ISO VG 460	Degol BG 460	Energol GR-XP460	Spartan EP 460	GEM 1 680	Mobilgear 634	Omala 460	Alpha SP 460
	0 ... +100	ISO VG 320	Degol BG 320	Energol GR-XP320	Spartan EP 320	GEM 1 460 GEM 1 320	Mobilgear 632	Omala 320	Alpha SP 320
	-5 ... +100	ISO VG 220	Degol BG 220	Energol GR-XP220	Spartan EP 220	GEM 1 220 GEM 1 150	Mobilgear 630	Omala 220	Alpha SP 220
	-5...+100	ISO VG 150	Degol BG 150	Energol GR-XP150	Spartan EP 150	GEM 1 100	Mobilgear 629	Omala 150	Alpha SP 150
	-5...+100	ISO VG 100	Degol BG100	Energol GR-XP100	Spartan EP 100		Mobilgear 627	Omala 100	Alpha SP 100
<i>Synthetic Oil</i>	-20 ... +140	ISO VG 680	Degol GS 680	Energol SG-XP680		Syntheso D 680 EP	Gylgoyle HE 680		
	-20 ... +140	ISO VG 460	Degol GS 460	Energol SG-XP460	Glycolube 460	Syntheso D 460 EP	Gylgoyle HE 460	Tivela SD	Alphasyn PG 460
	-25 ... +140	ISO VG 320	Degol GS 320	Energol SG-XP320	Glycolube 320	Syntheso D 320 EP	Gylgoyle HE 320		Alphasyn PG 320
	-25 ... +140	ISO VG 220	Degol GS 220	Energol SG-XP220		Syntheso D 220 EP	Gylgoyle HE 220	Tivela WB	Alphasyn PG 220
	-30 ... +140	ISO VG 150	Degol GS 150	Energol SG-XP 150		Syntheso D 150 EP			Alphasyn PG 150
	-30 ... +140	ISO VG 100		Energol SG-XP 100		Syntheso D 150 EP			
<i>Mineral Grease</i>	-20 ... +120		Aralup HL 3	Energol LS 3	Beacon 3	Centoplex 2	Mobilux 2	Alvania R3	Spherol APT 3
<i>Synthetic Grease</i>	-30 ... +100					ISOFLEX Topas L152	Mobiltemp SHC 100	Cassida RLS 00	

ELECTRICAL PROJECT

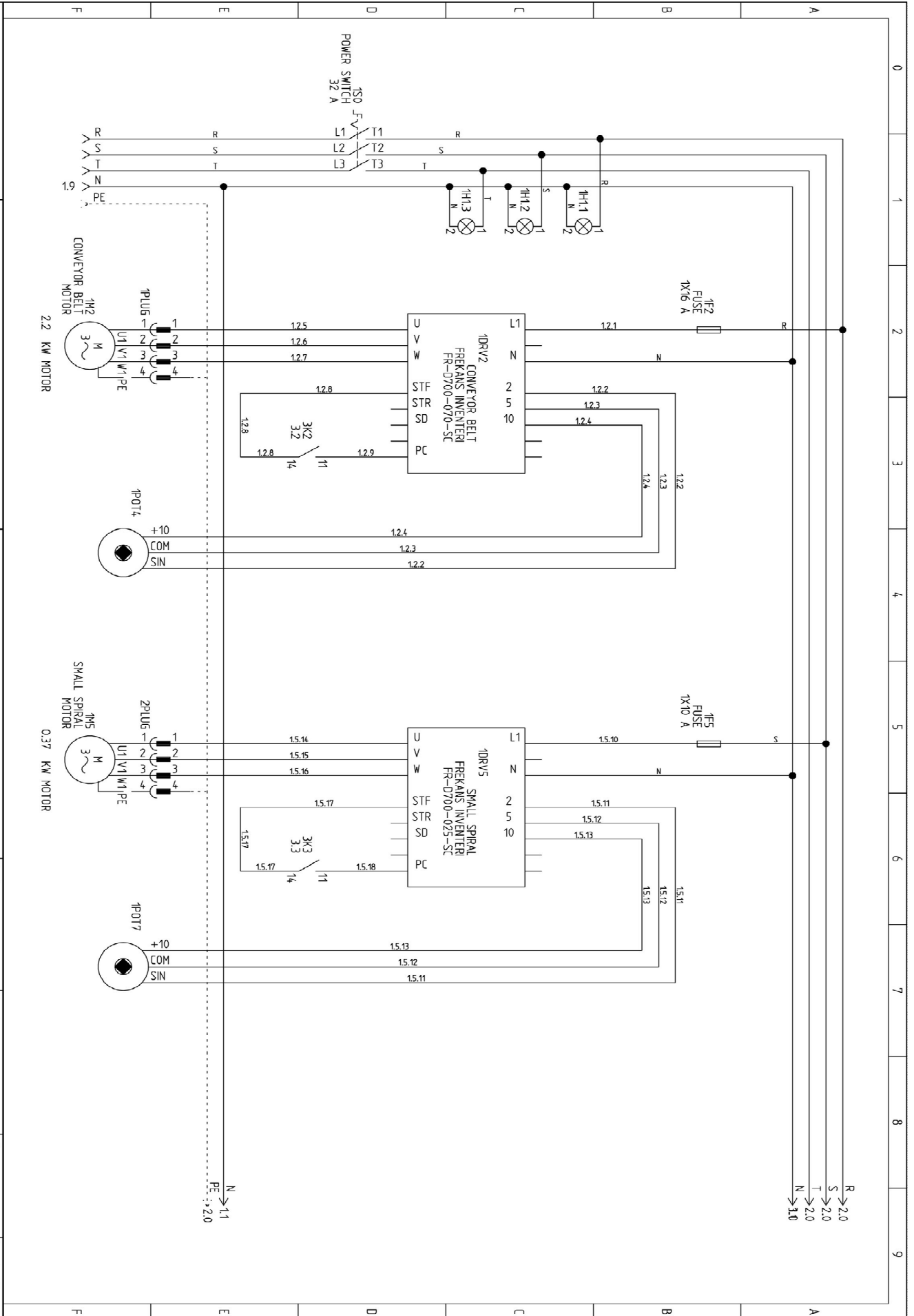

POWER PAGE

Proj no.: BANTI-TAMBUR
Date: 28.12.2015

Drawing no.:
Function: =
Location: +

Rev: 28.12.2015
Created by:

Page: 1

ELECTRICAL PROJECT

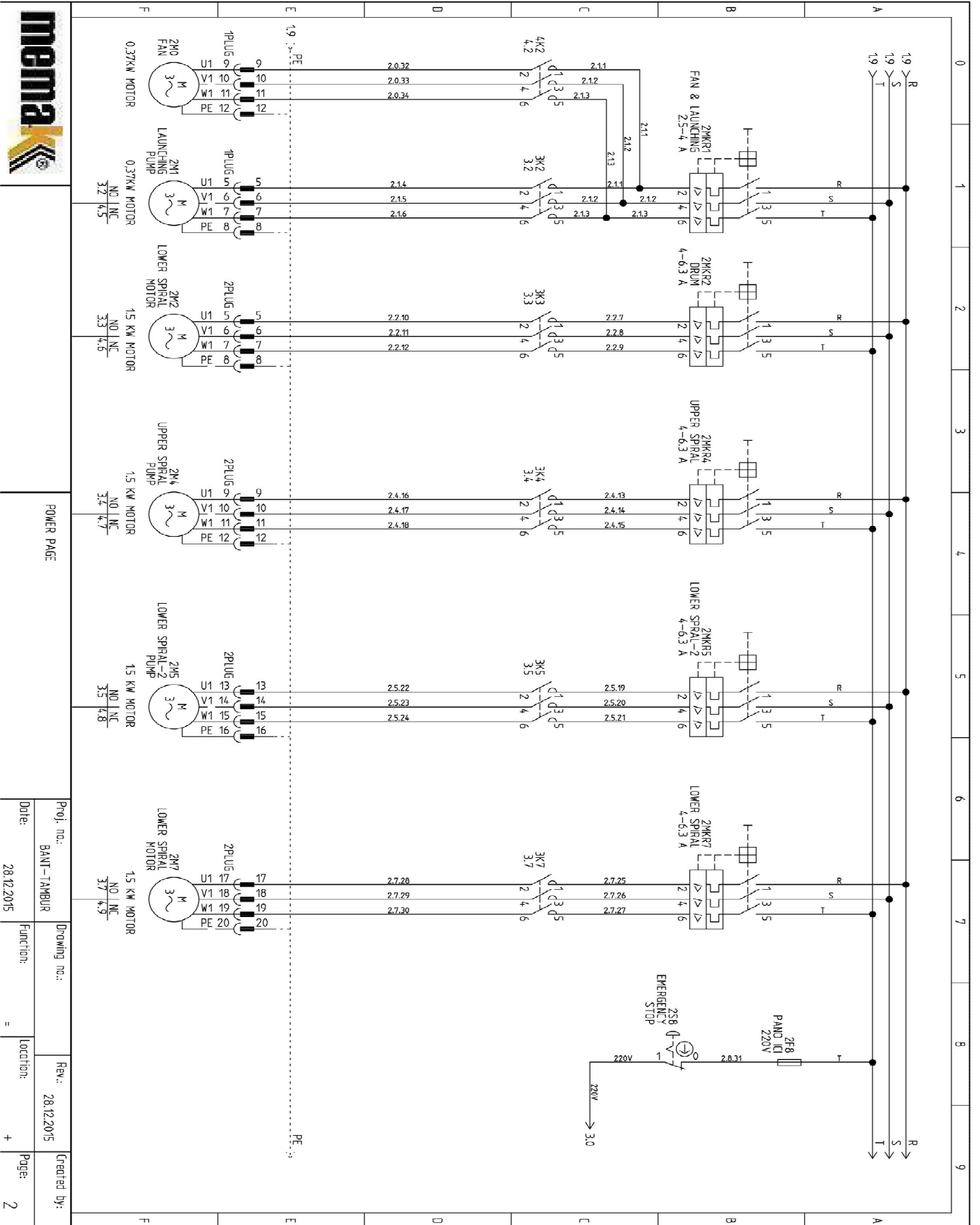

POWER PAGE

Proj. no.: BANT-TAMBUR
 Date: 28.12.2015
 Drawing no.:
 Function: =
 Location:
 Rev.: 28.12.2015
 Created by:

Page: 2

ELECTRICAL PROJECT

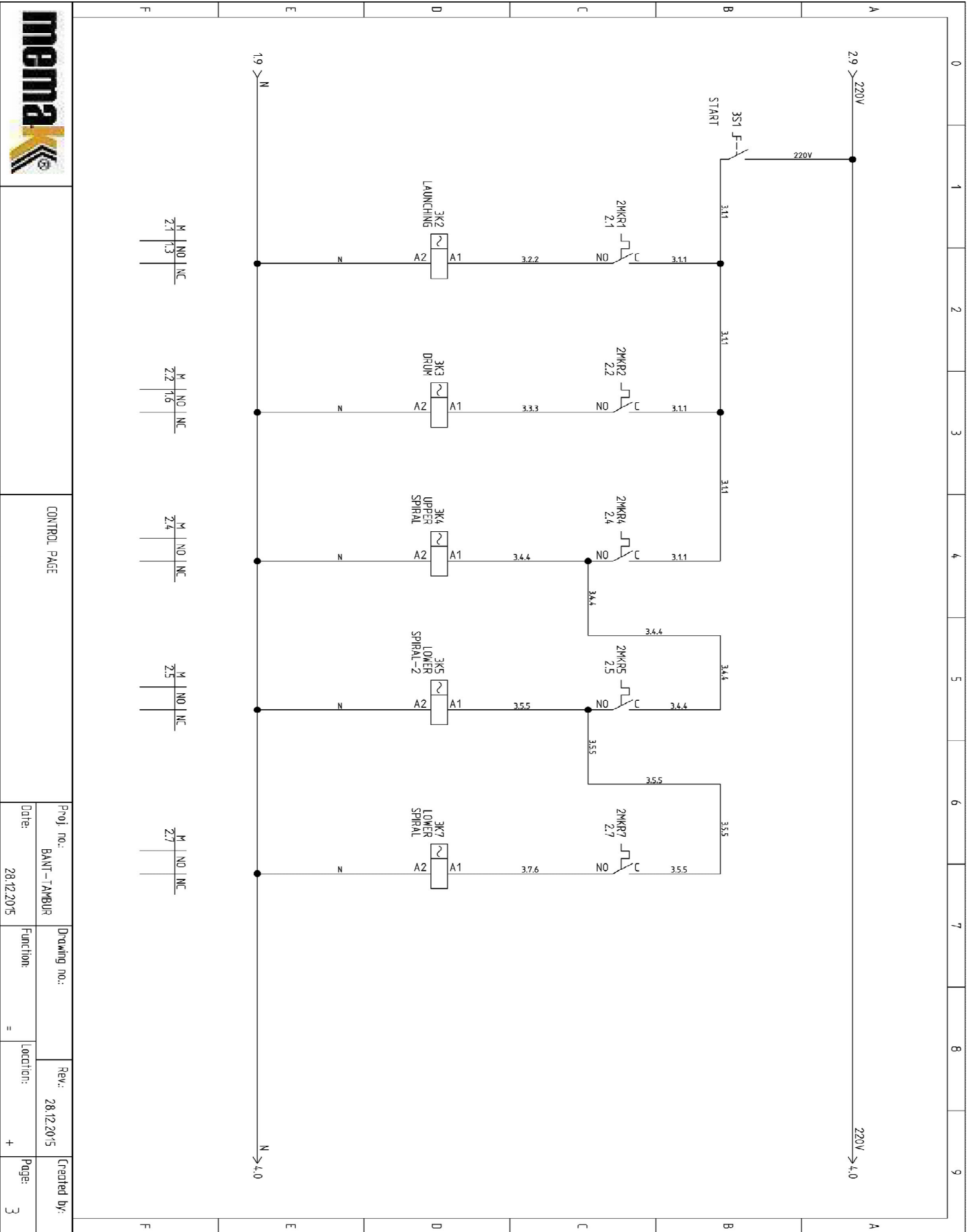

CONTROL PAGE

Proj no:	BANT-TANBUR	Drawing no:		Rev:	28.12.2015	Created by:	
Date:	28.12.2015	Function:	=	Location:	+	Page:	3

ELECTRICAL PROJECT

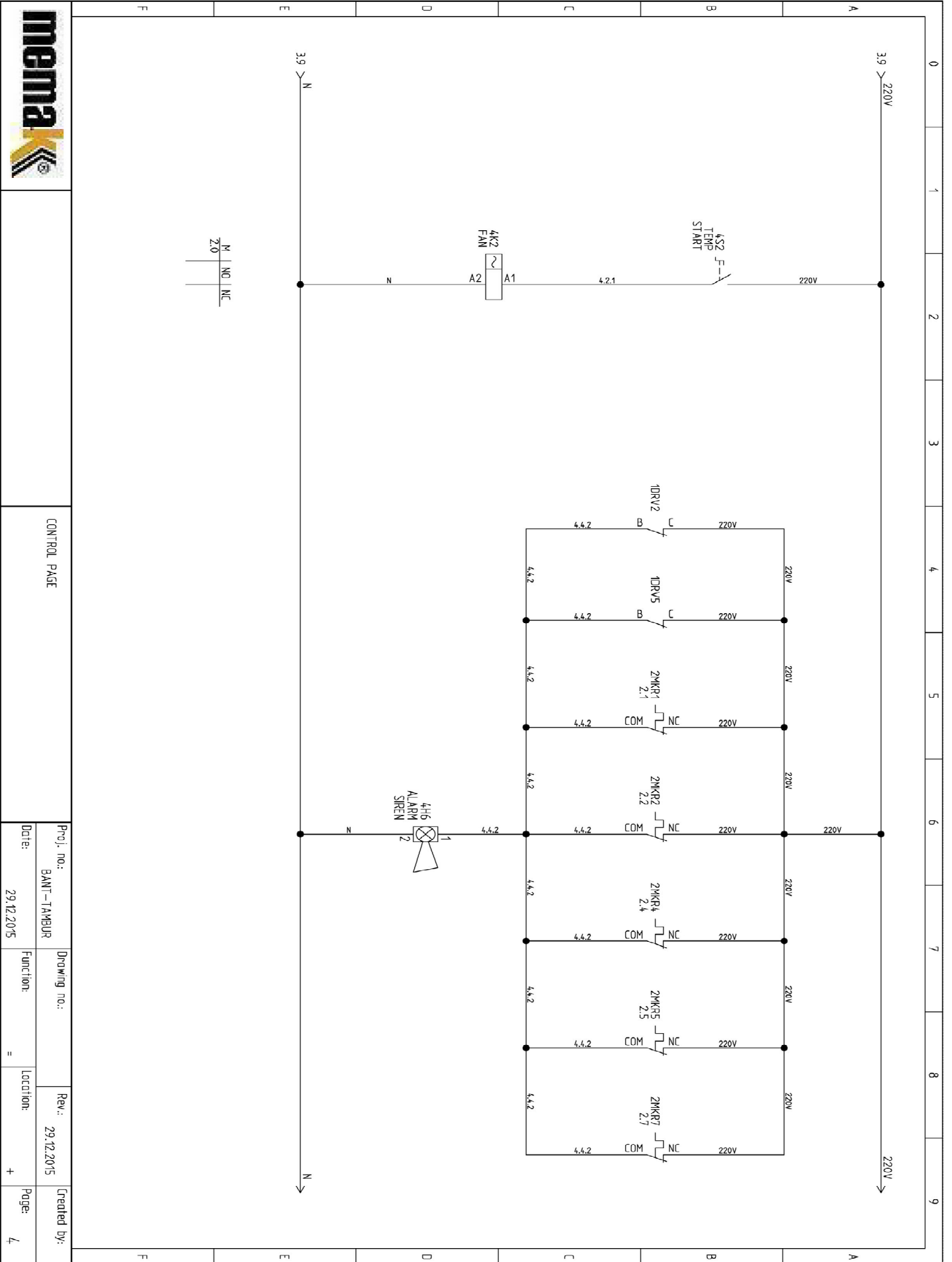

CONTROL PAGE

Proj. no:	BANT-TAMBUR	Drawing no.:	Rev.:	29.12.2015	Created by:
Date:	29.12.2015	Function:	=	Location:	+
					Page:
					4

LUBRICATION OF THE MACHINE

- ❖ *Gearbox for long life and good performance, the selection of the oil used must be accurate, and changes must be made at the specified times.*
- ❖ *In the election cycle of the oil, ambient temperature, hydraulic oil temperature, Operating conditions, and oil life is of importance.*
- ❖ *Gearboxes are shipped filled with oil. Gearboxes, they will be stored for a long time will begin to work according to the time or the working position when the plug supplied with the gearbox vent plug should be removed and the top should be used.*
- ❖ *Gearboxes as standard and used oils are given in the following table.*
- ❖ *B3 footed gearboxes, flanged reducers according to the position V1 was filled with oil. According to these positions, except for the addition or subtraction tables in working condition should be made to the amount of fat in it. It is recommended to consult with our firm in special working conditions.*
- ❖ *Mineral oil every 10,000 working hours in synthetic oils should be replaced every 20,000 operating hours. Severe environmental conditions (sudden temperature changes, high humidity, etc.) the shortening of oil change intervals is recommended.*
- ❖ *Mineral oils and synthetic oils definitely should not be confused together.*
- ❖ *Immediately after the replacement procedure of the study period, and should be done when the oil is hot. In this manner, a change in the oil inside the gearbox due to the presence of the particles involved in the casual vacancy will give you the results of a good cleaning and oil.*
- ❖ *Endless screw-in mineral oil it is recommended to replace the oil after the first 600 hours of the gearbox.*
- ❖ *The type of fat in the working position and, according to the amounts of fat are given in the following table.*